

DECADE II™

Raynor Traditions Series™

DELUXE • 1 OR 2-LAYER CONSTRUCTION  
STEEL OR STEEL + INSULATION

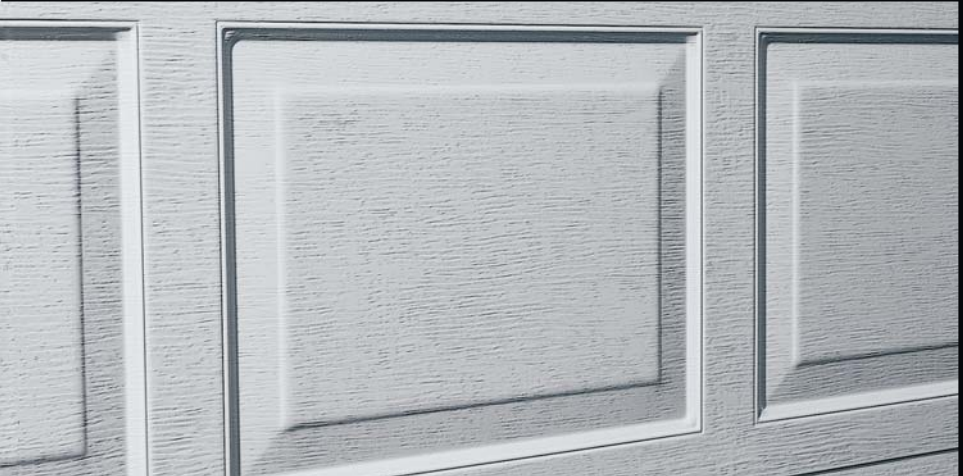

“FOR AS LONG AS YOU OWN YOUR HOME” SECTION WARRANTY



## Rugged Inside, Outside And In-Between.

Decade II, with flush-mounted stainless steel rivets, welded stile/rail construction, hot-dipped galvanized hardware and steel ball-bearing rollers, is built to work as great as it looks.

Decade II features tongue-and-groove meeting rail joints to seal out the elements. And the optional, environmentally safe, expanded polystyrene insulation increases energy efficiency and provides you with quieter door operation—a big advantage if you have an attached garage.

Choose the color that complements your home from a palette of five, then add your favorite panel design and window style to create a door that is uniquely yours.

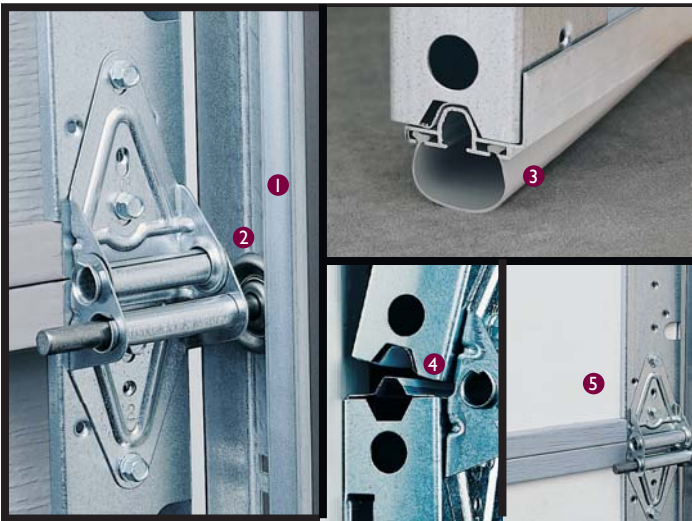

## Built To Last.

Decade II has heavy-duty, 24 gauge hot-dipped galvanized steel sections with an epoxy primer and a baked-on polyester finish to resist rust and impact. A galvanized steel track ❶ and durable, steel wheel, ball-bearing rollers ❷ assure long-lasting performance. To protect against the elements, a bottom weatherseal ❸ provides an effective barrier along the entire length of the door. Roll-formed tongue-and-groove meeting rails ❹ seal out wind, rain and snow. Finally, a thick core of optional polystyrene insulation ❺ helps keep your garage quieter and more comfortable.

## 2" Thick Door Sections

Decade II's 2" thick door sections are made from high-strength, impact-resistant 24-gauge steel.

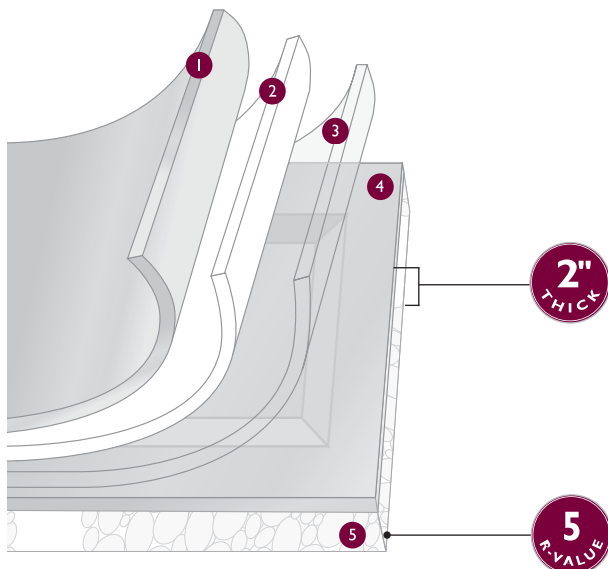

- ❶ Baked-on finish
- ❷ Epoxy primer
- ❸ Galvanized layer
- ❹ 24-gauge steel
- ❺ Optional polystyrene insulation



# Raynor Decorative Windows

Our beautiful window designs put the perfect finishing touch on your new Raynor Tradition Series™ garage door.

## Acrylic Leaded & Beveled Windows



Antique Black Ranch



Antique Brass Ranch



Regency Brass Colonial



Expressions Brass Colonial

## Frosted Leaded Glass

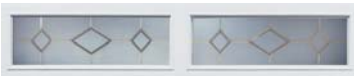

Diamond Ranch



Diamond Colonial



Ovals & Diamonds Ranch

## Frosted Beveled Glass



Sunrise Ranch



Sunrise Colonial



Pinnacle Colonial



Pinnacle Ranch

## Silkscreen Styles



Sherwood Colonial



Sunburst Ranch



Cathedral Colonial

## Snap-In Styles



Sherwood Colonial



Sunburst Colonial



Sunburst Ranch



Cathedral Colonial



Stockton Colonial



Stockton Ranch



Cascade Colonial



Cascade Ranch



Sunray Ranch

## Clear Glass



Colonial



Ranch

## Obscure Glass



Colonial



Ranch

## Sizes

Heights: 6'-6", 6'-8", 6'-9", 7'-0", 8'-0"  
Widths: 4'-0" to 20'-0"

## Door Designs



Colonial



Ranch

## Colors



White



Almond



Brown



Claytone



BronzeTone

## Openers

Raynor has a complete line of dependable openers to choose from.



Aviator™  
1/2 hp Belt Drive



Commander™  
1/2 hp Screw Drive



Pilot™  
1/2 hp Chain Drive



Navigator™  
1/3 hp Chain Drive

Deluxe

Standard

Economy

## Deluxe Warranty

Door Sections: "For As Long As You Own Your Home" against rust

Hardware/Springs: 5-Year

See your Raynor Dealer for complete details.

## Professional Installation From Your Raynor Dealer.

Every Raynor garage door is installed by a trained Raynor professional. Our expert installers make sure it's done right the first time, so your door gives you reliable performance day in and day out, year after year.

## Sections Warranted "For As Long As You Own Your Home."

The Decade II is covered by a "For As Long As You Own Your Home" section warranty against rust. Decade II is also backed by a 5-year track, spring and hardware warranty. See your Raynor Dealer for complete details.



Exclusively Distributed By:



RAYNOR WORLDWIDE  
P.O. Box 448, 1101 East River Road, Dixon, IL 61021-0448

1-800-4-RAYNOR (472-9667)  
[www.raynor.com](http://www.raynor.com)

This information was as complete and factual as possible at the time it was printed. We do, however, reserve the right to make product changes in specifications and availability without notice. Product colors have been reproduced as well as possible with present commercial printing processes. For absolute accuracy in color matching, use actual product samples.

Features and options may be different in countries other than the United States.